

## \*FOR APPROVAL ONLY\*

GENERAL NOTES	APPROVAL INITIALS
A. CAULK: BUTYL (24 TUBES) B. CAULK: SILICONE GREY (4 TUBES) C. ROOF CAP: DURO-LAST TAPERED MEMBRANE - 40 MIL - DIM A = 14' 0" DIM B = 10' 0" LAP LENGTH = 14' 0". D. EPS FOAM (SLOPED): DIM A=14' 0" DIM B=10' 0" SLOPE DIRECTION=8 0". E. SEPARATION SLIP SHEET: DURO-LAST DURO-BLU (1 ROLL) F. SILICONE FOR MEMBRANE (4 TUBES)	

KEY NOTES	APPROVAL INITIALS
1. RAMP: 30"Wx24"D - CENTER TO OPENING (N/T) 2. LIGHT FIXTURE: (1) EVERIDGE - 45W LED - 48" - TYPICAL	

COMPARTMENT SCHEDULE	APPROVAL INITIALS
C-01 HEIGHT: 92" -10°F FREEZER TO CEILING: LOCK DETAIL: B/Q-01 LOCK TO FLOOR (NSF) DETAIL: C/Q-01 WALL PANEL RAIL: FOAM THICK: 4" DETAIL: C/Q-01 FINISHES: INT/EXT - ACRYLUME/EMBOSSD - 26 GA CEILING PANEL RAIL: FOAM THICK: 5" FINISHES: INT/EXT - ACRYLUME/EMBOSSD - 26 GA FLOOR PANEL RAIL: FOAM THICK: 4 1/8" RECS: X" FINISHES: INTERIOR - ALUMINUM/SMOOTH - .050 EXTERIOR - ACRYLUME/EMBOSSD - 26 GA	

DOOR SCHEDULE - SWING	APPROVAL INITIALS
D01 36"W x 78"H FREEZER SLIP MOUNT ALLOWANCE DETAIL: D/Q-01 FLUSH MOUNT CLOSER: KASON 1094 VENT: KASON 1825 115V HEATED VIEWPORT: HINGE: KASON 1248 QTY: 2 LATCH: KASON 27C RELEASE: SWITCH / ALARM: 1967-2 DIGITAL THERMOMETER W/ SWITCH LIGHT: KASON 1806 - LED (MOUNTED TO JAMB) MAGNETIC GASKET RAIN HOOD (HINGED) DOOR JAMB HEAT (120V) - "X" = YES JAMB: X B.O. DOOR THRESHOLD: X	

REFRIGERATION	APPROVAL INITIALS
CONDENSING UNIT FOR HOLDING FREEZER • MANUFACTURER: HTPG - RUSSELL DCE • DESCRIPTION: HEAT GEN MINI-CON CONDENSING UNIT LOW TEMPERATURE SCROLL COMPRESSOR: 208-230V/180 FLOODED NO DEFROST PROVISIONS • MODEL: RPO20XL4SDANT • HORSEPOWER: 2.3333HP • EXTRAS: • ELECTRICAL: 208-230V/180, RLA 12.4359, MOPD 25, MCA 17.5 • CONDITIONS: BTUH 7330 ROOM TEMP -10°F AMBIENT 95°F • WARRANTY: COMPRESSOR/MOTOR WARRANTY EXTENDED TO 5-YEARS, PARTS ONLY, NO LABOR 1 X EVAPORATOR UNIT COOLER • MANUFACTURER: HTPG - RUSSELL DCE • DESCRIPTION: ELECTRIC DEFROST LOW-PROFILE WITH DUAL SPEED EC MOTOR COIL • MODEL: RL6E07DDARE • EXTRAS: NONE • ELECTRICAL: 208-230V/180, FAN AMPS 1, DEFROST AMPS 9.8	

**W+**  
**WIGHTMAN**  
BENTON HARBOR  
269.927.0100  
KALAMAZOO  
269.327.3532  
ALLEGAN  
269.673.8465  
ROYAL OAK  
248.791.1371  
[www.gowightman.com](http://www.gowightman.com)

**EVERIDGE**  
Every step of the way.  
**THERMALRITE**  
EVERIDGE  
15600 37TH AVE N. SUITE 100  
PLYMOUTH, MN 55446  
PHONE: (763) 541-1410 FAX: (763) 541-1563  
<https://www.everidge.com>

**COMPLIANCE**  
WALK-INS MEET OR EXCEED ALL PRESCRIPTIVE STANDARDS OF THE ENERGY INDEPENDENCE AND SECURITY ACT (EISA) OF 2007  
**REFERENCE SYMBOL LEGEND**

**KEY NOTE**  
ELEVATION REF: X  
SECTION REF: X  
DETAIL REF: X  
DATUM POINT: X  
**KEY NOTE**  
DOOR TAG: DXX  
COMPARTMENT TAG: C-XX  
JAMB GUARDS: JG  
DAIRY LIP: DL  
T-MOLDING: TM  
REVISION NUMBER: X

**SITE NOTATION**  
• WHEN APPLICABLE - DOES BUILDING FLOOR HAVE TILE AND GROUT INSTALLED BEFORE OR AFTER WALK-IN INSTALLATION IF SO PROVIDE TILE THICKNESS  
• ALLOW 2" FOR COOLER AND FREEZER MINIMUM AIR SPACE ALL AROUND WALK-IN FOR AMPLE AIR CIRCULATION

**WARNINGS:**  
• TO AVOID DOOR DAMAGE, DO NOT REMOVE FREEZER DOOR HEATERS PRIOR TO STARTUP OF REFRIGERATION  
• TO AVOID DISCOLORATION OF METAL ON PANELS, PROPERLY VENTILATE EACH ROOM IF THE OR MASONRY WORK IS TO BE DONE  
**CONSTRUCTION (STANDARD)**  
• CORNERS AND T-WALLS TO BE ONE PIECE CONSTRUCTION W/ 3/8" RADIUS AT ALL INSIDE VERTICAL CORNERS, JOINTS SEALED W/ PVC GASKET AT INT. & EXT. PERIMETER OF PANELS, CONNECTED W/ CAM-LOCK FASTENERS  
• ALL CEILING AND WALL PANELS ARE NOT DESIGNED TO CARRY ADDITIONAL CONDENSING UNIT WEIGHT UNLESS SPECIFICALLY NOTED OTHERWISE AND DESIGNATED IN PLAN

**ELECTRICAL NOTICE**  
• ALL ELECTRICAL COMPONENTS WITHIN THE WALK-INS, IE LIGHT SWITCHES, PRESSURE RELIEF PORTS, JAMB HEATERS SHALL BE FACTORY PRE-WIRED, FOR HOOK UP BY ELECTRICAL CONTRACTOR  
• ALL LIGHT FIXTURES SUPPLIED ARE SHIPPED LOOSE FOR INSTALLATIONS BY ELECTRICAL CONTRACTOR  
• ThermalRite SHALL ACCEPT NO RESPONSIBILITY FOR ANY BACK CHARGES ASSOCIATED WITH INSTALLATION OF LIGHT FIXTURES OR FIELD WIRING CONNECTIONS.

**CONCRETE SLAB / PAD NOTICE**  
• SLAB / PAD MUST BE LEVEL WITHIN 1/4" OVER 10'-0" IN ANY DIRECTION  
• SLAB / PAD MUST BE FLAT, SMOOTH, AND UNIFORM WITH MAXIMUM 1/4" TOTAL DEVIATION OVER 10'-0" STRAIGHTEDGE IN ANY DIRECTION  
I HEREBY ACKNOWLEDGE THAT I HAVE BEEN INFORMED OF THE ABOVE SLAB / PAD REQUIREMENTS AND FAILURE TO COMPLY WILL RESULT IN REFUSAL TO INSTALL AND/OR WILL VOID ANY WARRANTY COVERAGE FOR ISSUES ON THIS WALK-IN RESULTING FROM SUCH INSTALLATION.  
X

8/12/2022- For State Plan Review

1			
REV	DESCRIPTION	DATE	BY

Approval Status Block  
Drawing Reviewed By:  
Review Date:  
Please Check Appropriate Field  
Approved as Drawn: ☐  
Revise and Resubmit: ☐  
Customer Service Rep.  
CHRIS EVERS  
Submittal Drafter Shop Drafter  
BS

Save Dwg Date: 8.9.2022

Customer/Dealer  
SEFA - GREAT LAKES HOTEL SUPPLY (MI)  
24101 W 9 MILE RD  
SOUTHFIELD, MI 48033-3972

Site Information  
OTTAWA ELEMENTARY  
BUCHANAN MI 49107  
Create Dwg Date: 08.09.2022  
Project # E035959-01  
Sheet # Q-01

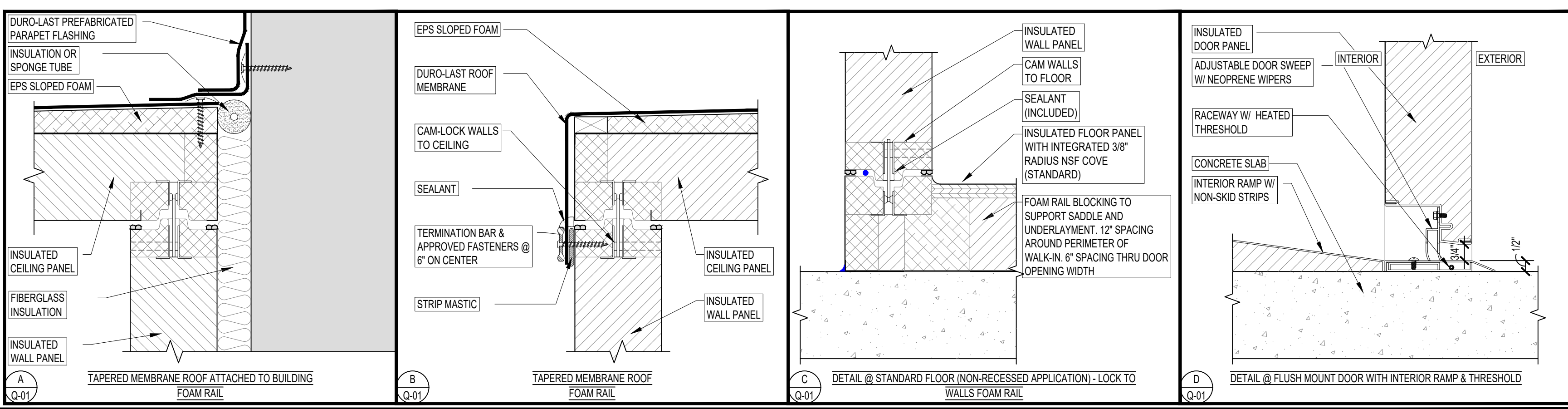

\*FOR APPROVAL ONLY\*



15600 37TH AVE N. SUITE 100  
PLYMOUTH, MN 55446  
PHONE: (763) 541-1410 FAX: (763) 541-1563  
https://www.everidge.com



COMPLIANCE

WALK-INS MEET OR EXCEED ALL PRESCRIPTIVE STANDARDS OF THE ENERGY INDEPENDENCE AND SECURITY ACT (EISA) OF 2007

SITE NOTATION

- WHEN APPLICABLE - DOES BUILDING FLOOR HAVE TILE AND GROUT INSTALLED BEFORE OR AFTER WALK-IN INSTALLATION IF SO PROVIDE TILE THICKNESS
- ALLOW 2" FOR COOLER AND FREEZER MINIMUM AIR SPACE ALL AROUND WALK-IN FOR AMPLE AIR CIRCULATION

WARNINGS:

- TO AVOID DOOR GASKET DAMAGE, DO NOT ENERGIZE FREEZER DOOR HEATERS PRIOR TO STARTUP OF REFRIGERATION
- AVOID DISCOLORATION OF METAL ON PANELS. PROPERLY VENTILATE EACH ROOM IF TILE OR MASONRY WORK IS TO BE DONE

CONSTRUCTION (STANDARD)

- CORNERS AND T-WALLS TO BE ONE PIECE CONSTRUCTION W/ 3/8" RADIUS AT ALL INSIDE VERTICAL CORNERS, JOINTS SEALED W/ PVC GASKET AT INT. & EXT. PERIMETER OF PANELS, CONNECTED W/ CAM-LOCK FASTENERS.
- ALL CEILING AND WALL PANELS ARE NOT DESIGNED TO CARRY ADDITIONAL CONDENSING UNIT WEIGHT UNLESS SPECIFICALLY NOTED OTHERWISE AND DESIGNATED IN PLAN

ELECTRICAL NOTICE

- ALL ELECTRICAL COMPONENTS WITHIN THE WALK-INS, I.E. LIGHT SWITCHES, PRESSURE RELIEF PORTS, JAMB HEATERS SHALL BE FACTORY PRE-WIRED, FOR HOOK UP BY ELECTRICAL CONTRACTOR
- ALL LIGHT FIXTURES SUPPLIED ARE SHIPPED LOOSE FOR INSTALLATIONS BY ELECTRICAL CONTRACTOR
- ThermalRite SHALL ACCEPT NO RESPONSIBILITY FOR ANY BACK CHARGES ASSOCIATED WITH INSTALLATION OF LIGHT FIXTURES OR FIELD WIRING CONNECTIONS.

CONCRETE SLAB / PAD NOTICE

- SLAB / PAD MUST BE LEVEL WITHIN 1/4" OVER 10'-0" IN ANY DIRECTION
- SLAB / PAD MUST BE FLAT, SMOOTH, AND UNIFORM WITH MAXIMUM 1/4" TOTAL DEVIATION OVER 10'-0" STRAIGHTEDGE IN ANY DIRECTION

I HEREBY ACKNOWLEDGE THAT I HAVE BEEN INFORMED OF THE ABOVE SLAB / PAD REQUIREMENTS AND FAILURE TO COMPLY WILL RESULT IN REFUSAL TO INSTALL AND/OR WILL VOID ANY WARRANTY COVERAGE FOR ISSUES ON THIS WALK-IN RESULTING FROM SUCH INSTALLATION.

X



**WIGHTMAN**

**BENTON HARBOR**  
269.927.0100

**KALAMAZOO**  
269.327.3532

**ALLEGAN**  
269.673.8465

**ROYAL OAK**  
248.791.1371

[www.gowightman.com](http://www.gowightman.com)

8/12/2022- For State  
Plan Review

1			
---	--	--	--

REV	DESCRIPTION	DATE	BY
-----	-------------	------	----

Approval Status Block

Drawing Reviewed By:

Review Date:

Please Check Appropriate Field

Approved as Drawn: ☐

Revise and Resubmit: ☐

Customer Service Rep.

CHRIS EVERS

Submittal Drafter Shop Drafter

BS

Save Dwg Date: 8.9.2022

Customer/Dealer

SEFA - GREAT LAKES HOTEL SUPPLY (MI)  
24101 W 9 MILE RD  
SOUTHFIELD, MI 48033-3972

Site Information

OTTAWA ELEMENTARY

BUCHANAN MI 49107

Create Dwg Date: 08.09.2022

Project # E035959-01

Sheet # QE-01

